

DispenseMate[®] 583 Dispensing System
DispenseMate[®] 585 Dispensing System

DispenseMate 580 Series Installation Guide

The DispenseMate 580 Series Dispensing System (D-580) brings new dispensing power to a compact package. The D-580 Series platform utilizes the same dispense control technology as some of Asymtek's most advanced Dispensing Systems. Two models of the DispenseMate Dispensing Systems are available with different size dispensing areas, the D-583 and D-585 Dispensing Systems. Refer to the *DispenseMate 580 Series User Guide* for additional information on each system.

The D-580 Series Dispensing Systems are designed to sit on top of a standard height (800 mm or 30-inch) work bench; however work benches vary in stability and strength. The stability of the work bench will directly influence the dispensing results. For best results, the use of an optional welded machine base (Asymtek P/N 193418) is recommended.

The Dispensing System utilizes Asymtek's Fluidmove[®] for Windows XP (FmXP) software, the same industry-proven software package used on all Asymtek Dispensing Systems. FmXP and DispenseMate's flexible architecture makes it easy for customers to upgrade as needed, and provides the portability to develop programs offline that can be transferred to other sites or moved to inline systems. CAD Import software and Automatic Pattern Recognition are also available.

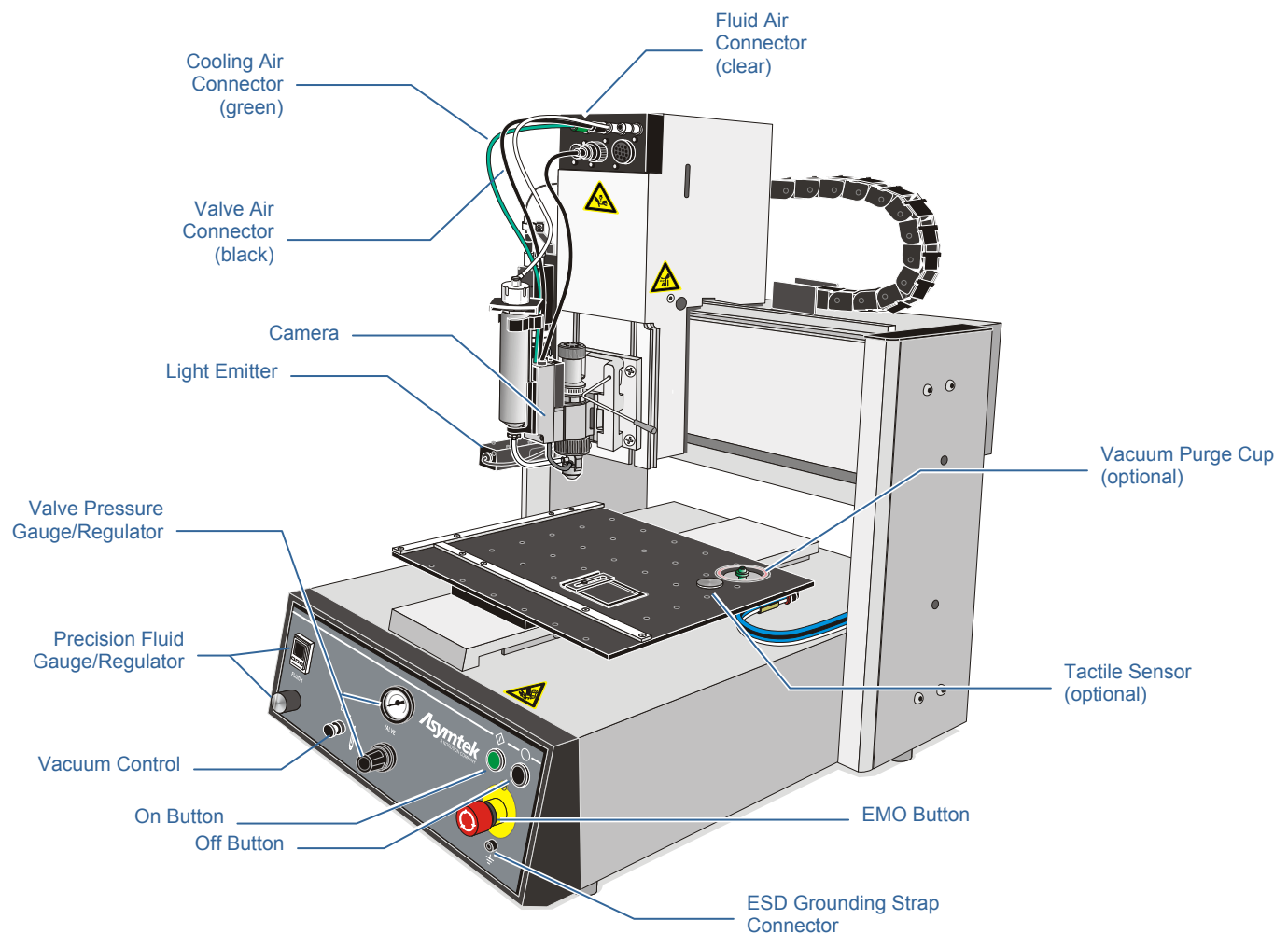

Front View Features

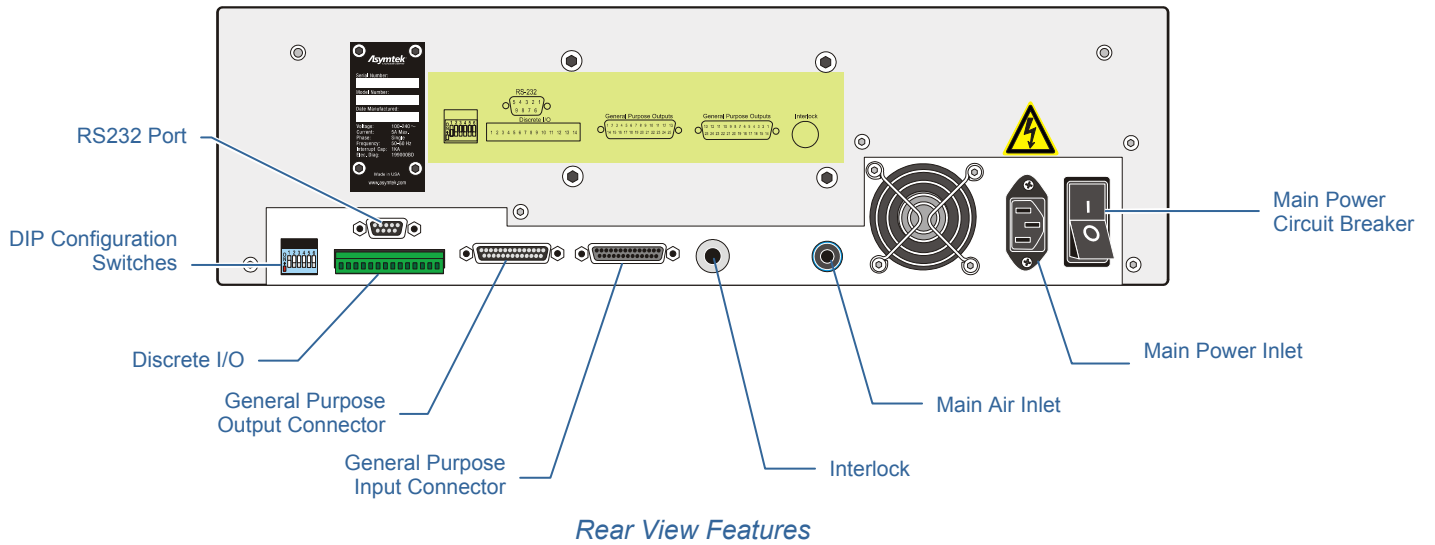

Dispensing Valve Configuration			
Valve Model	Valve Air Connection	Fluid Pressure Connection	Cooling Air Connection
DJ-9000/DJ-2100 DispenseJet® Series	Black fitting	Clear fitting	Green fitting
DV-7000/DV-8000 Heli-Flow® Pumps	N/A	Clear fitting	
DV-01	N/A	Clear fitting	
DV-07	Black fitting	Clear fitting	
DV-03HPA	Black fitting	Clear fitting	
DV-05A	Black fitting	Clear fitting	
DV-07	Black fitting	Clear fitting	
DV-09	Black fitting	Clear fitting	

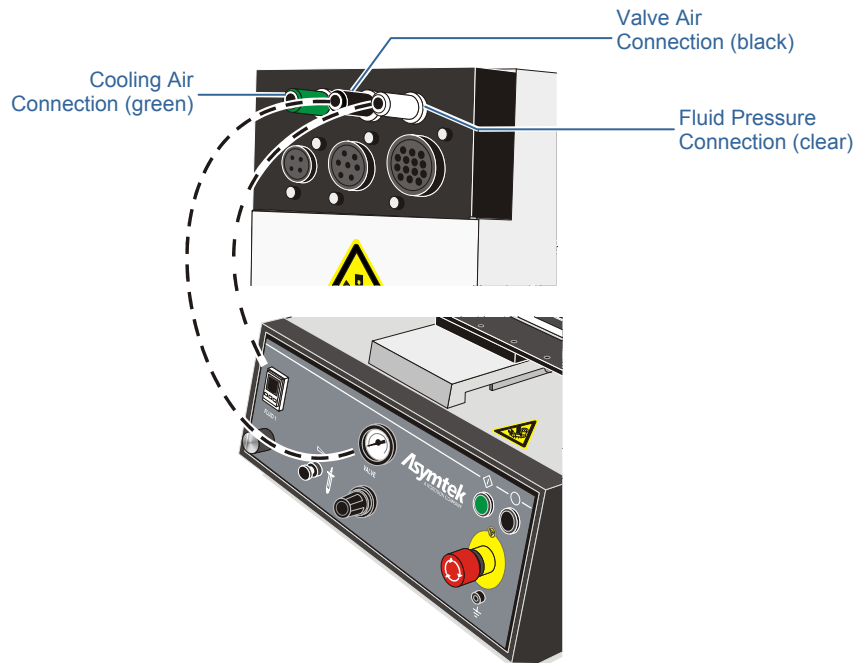

Safety

- Installation procedures should only be performed by a trained service technician.
- Before performing any of the System installation procedures in this guide, please review the *Safety* section presented in the *DispenseMate 580 Series User Guide*.
- Disconnect and place a warning tag on the Main Power Inlet before performing maintenance or service.
- Disconnect and place a warning tag on the Main Air Pressure Gauge and Regulator before performing maintenance or service.
- When adjusting pressure with regulators, always reduce the pressure below the desired range before turning the pressure back up.
- There is an important correlation between the position of the Dispensing Valve tip and the Height Sensor Probe. Always adjust the Height Sensor Probe after a valve or needle length change.

Uncrate and Place the Dispensing System

1

Tools and Materials Needed:

- Band Cutter
- Hammer
- Flat Bar
- Appropriate personal protective equipment

1. Locate and remove the envelope on the outside of the shipping crate. Open the envelope and locate the shipping list.
2. Cut the four bands that secure the lid to the crate. Remove the lid, four cardboard corners, and plastic sleeve.
3. Remove the poly bag from the unit and cut the bands that secure the Dispenser to the crate bottom.
4. Place the Dispensing System near the installation site.
5. Remove all perimeter packaging material from the dispensing area.
6. Remove all tie wraps, tape, foam packaging material, and warning tags from the Dispensing Head and Tooling Plate.



NOTE

Location of packaging materials to be removed is indicated by the presence of warning tags.

7. Use the flat bar and hammer to remove the crate and unpack the accessories crate.
 - ▶ As you unpack each item inside of the box, identify the item, locate it on the shipping list, and place a checkmark next to the item.



WARNING!



CAUTION!

Personnel should wear gloves and safety glasses while removing the top and sides of the crate.



NOTE

The contents of the accessories crate will vary depending upon the options ordered with your Dispensing System.

Install the Computer

2

1. Locate the Laptop Computer, remove all packaging material, and place it in the desired location.
2. Connect the USB 2.0 Cable (P/N 7209541) to the USB Type B connector at the right, rear of the DispenseMate and to the USB port on the Computer.
3. If the unit is furnished with the Advanced Dispensing Package, connect the RJ-45 Ethernet cable (P/N 7209539) between the laptop and the left, rear Ethernet connection on the Dispenser.
4. Plug the Computer Power Cable and the Dispenser Power Cable into the facility outlet.

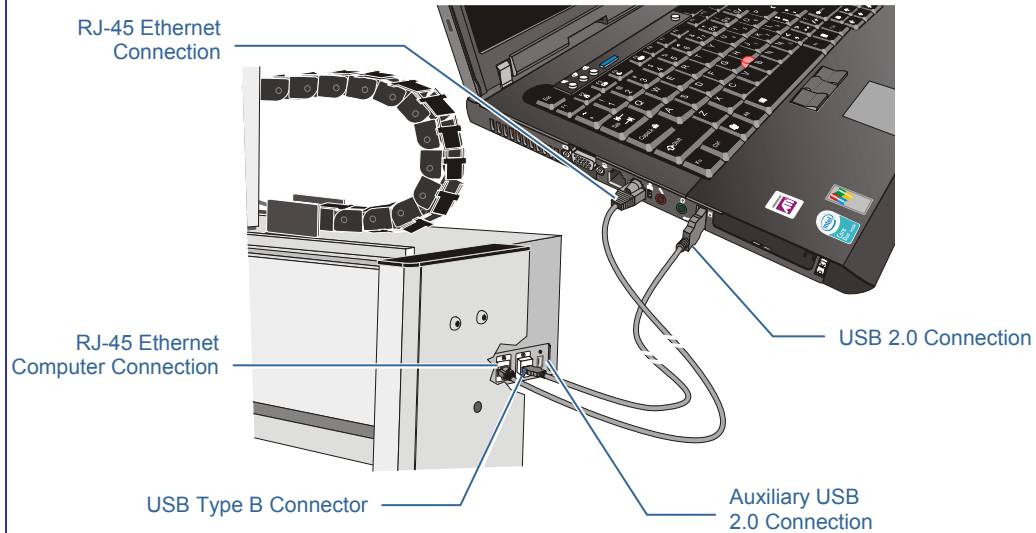

Install and level the Tooling Plate

3

The D-580 Series Dispensing Systems are supplied with Tooling Plates that are adjusted to ± 0.127 mm of the X-Y Dispense Plate level. To prevent damage during shipping, the plate is secured with a temporary bracket and screws. Remove the bracket and screws and replace the screws with the (4) M4 button head screws provided prior to use.



NOTES The leveling set screws are preset at the factory and in most cases do not need adjustment.

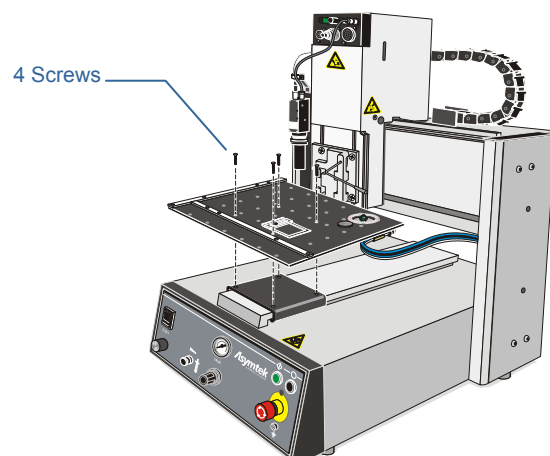

Install the Dispensing Valve

4

Prior to installing the Dispensing Valve, loosen (do not remove) the four (4) screws on the Z-axis face plate and slide the face plate up so that it is flush with the Z-axis extrusion. Tighten the screws on the face plate.

To install the Dispensing Valve, slide the dovetail bracket (included with the Dispensing Valve) into the Valve Mounting Bracket on the Z-axis face plate. Secure by tightening the quick release lever on the Valve Mounting Bracket. Refer to the *DispenseMate 580 Series User Guide* for additional information.



NOTE

After the Dispensing Valve has been installed, you must adjust the Height Sensor Probe. Refer to the *DispenseMate 580 Series User Guide* for additional information.

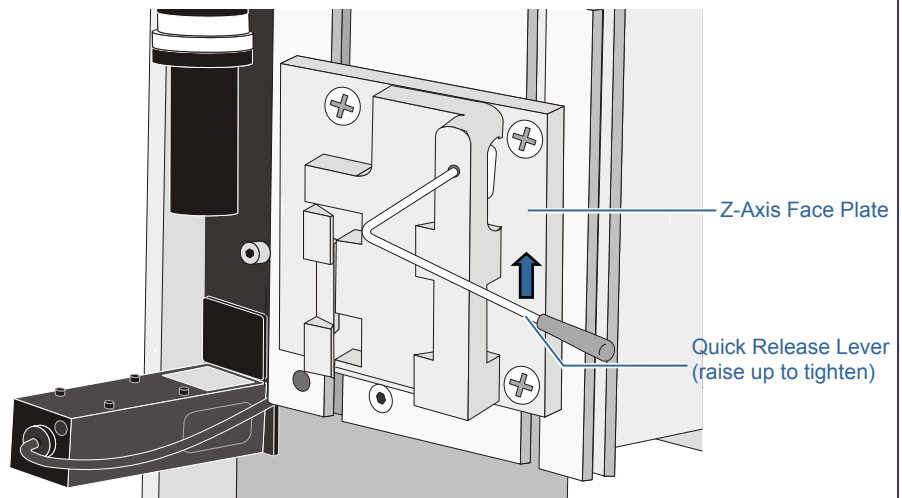

Electrical Connections

5

Electrical Requirements for the DispenseMate 583/585 Dispensing Systems are as follows:

Main Power Supply	
D-583	1 kw of single-phase power at 100/120/220/240 VAC; 50/60 Hz; 10 A
D-585	

Board wiring connections are installed in the factory before the product is shipped.



NOTE

Refer to of the *DispenseMate 580 Series User Guide* for information on available electrical diagrams or contact your Asymtek Representative.

6

Connect the air supply to the 1/4-inch NPT quick-disconnect fitting at the facility air connection. Refer to the *Specifications* section of the *DispenseMate 580 Series User Guide* for additional information on System specifications.

To connect Facility Air Supply:

1. Attach a quick-disconnect air fitting (customer supplied) to the facility air hose.
2. Connect the facility air hose to the Main Air Pressure Regulator Inlet.
3. Connect the outlet of the Main Air Pressure Regulator to the Main Air Inlet on the rear of the Dispensing System.

 **NOTES** The maximum air supply pressure should not exceed 100 psi (689 kPa). Refer to the *DispenseMate 580 Series User Guide* for additional information on pneumatic diagrams.



WARNING!



CAUTION!

All System Pneumatic Connections should be checked before the Main Air is connected.

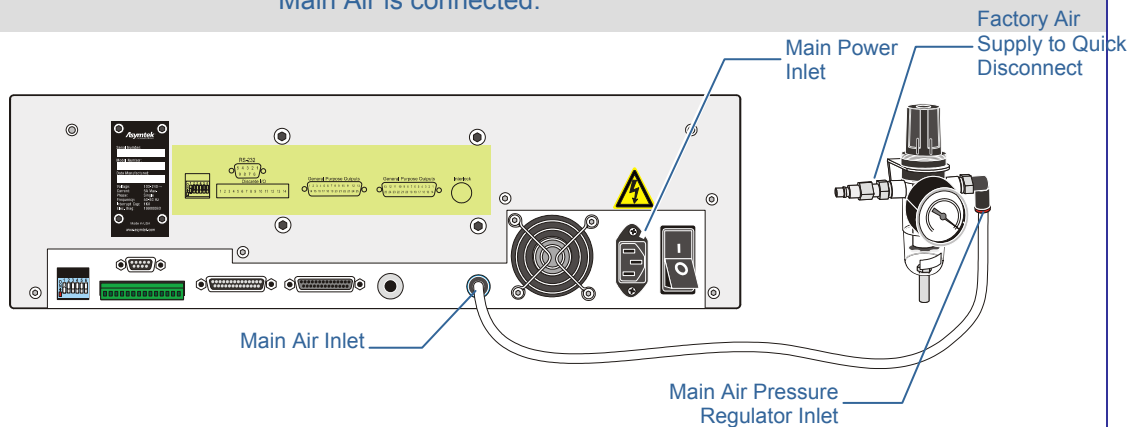

7



WARNING!



CAUTION!

Make sure your facility meets all requirements listed in the *Specifications* section of the *DispenseMate 580 Series User Guide*. Failure to meet these requirements could result in serious bodily injury to personnel and damage to the Dispensing System.



CAUTION!

This procedure should only be performed by a trained service technician.

To connect Facility Power:

1. Unpack the Main Power Cable and remove all packing material including plastic wrappers and tie wraps.
2. Plug the female end of the Power Cable into the Main Power Inlet on the back of the Dispensing System. Plug the male end of the Power Cable into the facility power source.

System Power-Up

8

If necessary, refer to Front View Features in this guide to identify Dispensing System components.

1. Verify that the Main Power Cable is connected to the Main Power Inlet and the facility power source.
2. Verify that the facility air is at the recommended pressure level and connected to the Main Air Pressure Regulator Inlet. Refer to the *DispenseMate 580 Series User Guide* for additional information.
3. Turn the Main Power Circuit Breaker on the back of the Dispensing System to the **ON (I)** position.
4. The System Computer should begin the boot up sequence.
5. Check the EMO button to see if it has been activated. If it has been activated, deactivate it by turning the red knob counterclockwise until the knob pops out.
6. Make sure the Interlock signal is not interrupted. Close the Dispensing System enclosure if applicable.
7. Press the **ON (I)** button on the front panel.
8. The Dispensing System should be in a powered-up state and the digital gauges and green power button should be on. If not, make sure the power cable is properly connected to the Dispensing System and to an active facility power source.



This equipment is regulated by the European Union under WEEE Directive (2002/96/EC). Refer to www.nordson.com for information about how to properly dispose of this equipment.



Asymtek Headquarters
2762 Loker Avenue West
Carlsbad, CA 92010-6603 USA
Tel: (760) 431-1919
1-800-ASYMTEK (1-800-279-6835)